

Patios & Folding Sliding Doors

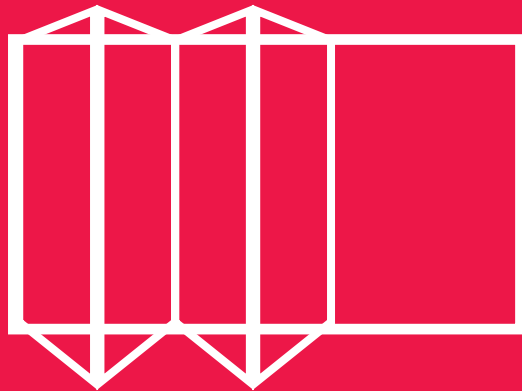



Choosing Hardware for Your Patio & Folding Sliding Doors

IDENTIFICATION

Mila stock a comprehensive range of gearing and accessories to suit the following types of doors:

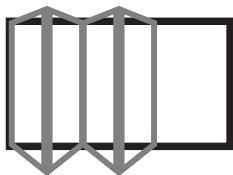

Folding Sliding Doors

Folding sliding doors are a contemporary alternative to patio doors or French doors. When fully opened the doors concertina back on themselves providing wider opening areas. Various opening options are available combining two to seven panes and with outer frame widths up to 6300mm.



Inline or Straight Sliding

Inline patio doors are the traditional style of patio door fitted in the UK. They feature a multipoint lock for security and slide parallel to the fixed leaf on patio rollers.

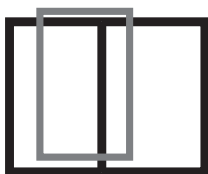

Lift & Slide

Lift and slide patios work on a simple rule: lift, slide, drop. All operations are controlled via the handle and associated gearing. Lift and slide patios offer greater variations in terms of opening combinations than traditional inline or tilt and slide patios.

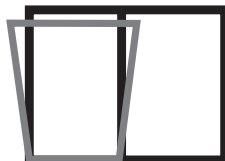

Tilt & Slide

Tilt and slide patios can be tilted for ventilation or opened fully for ventilation and/or access.

The patio functions are controlled via a handle which also operates central locking gear for security and weather sealing.

Patio & Folding Sliding Doors Selection Guide



AT A GLANCE PRODUCT MATRIX

	Page:	Finish: Polished Gold	Finish: Polished Chrome	Finish: Smooth Satin Chrome	Finish: Smokey Chrome	Finish: White	Finish: Black	Finish: Anodised Gold F3	Finish: Anodised Silver F1	Application: Patio	Application: Folding Sliding	Accreditation: Secured by Design	Accreditation: BSI Kitemark	Guarantee: 5 Year Surface Finish	Guarantee: 10 Year Surface Finish	Guarantee: 5 Year Mechanical	Guarantee: 10 Year Mechanical
ProSecure Patio Handle	323	✓	✓	✓	✓	✓	✓		✓			✓	✓	✓			
ProLinea Patio Handle	325	✓	✓	✓	✓	✓	✓		✓					✓	✓		✓
Tilt & Slide Patio Handle	327						✓	✓	✓					✓			
PSK 160 Plus Tilt & Slide	329								✓					✓			
Siegenia HS Portal Lift & Slide	331								✓					✓			
Siegenia FS Portal Folding Sliding	333									✓				✓			
Yale 6 Hook Patio Lock	335								✓			✓		✓			
Yale 4 Hook Patio Lock	337								✓			✓		✓			
Patio Stops	339																
Patio Rollers	340																



ProSecure Patio Handle

Enhanced Security



PRODUCT DESCRIPTION



Enhanced security patio handle with a raft of intelligent design features:

- Manufactured from zinc alloy
- Anti-grip chamfered backplate shoulders provide mole-grip resistance
- Anti-drill rotating disc shields the cylinder face from attack, preventing a drill bit from penetrating the cylinder
- Anti-snap integrated cylinder guard, visible within the raised backplate design, encases the cylinder to protect it from attack - no need for an anti-snap cylinder
- Steel reinforcement technology concealed within the standard backplate size provides anti-jimmy resistance
- Patented FlexSecure® Technology enables innovative ball joints to flex when the backplate is under attack to prevent the fixings screws from shearing or snapping
- Independently tested at Exova to PAS 024: 2012 and TS007: 2012
- Police Preferred Specification - Secured by Design accredited, SBD logo etched onto external backplate acts as a visual deterrent
- BSI 2 star Kitemark accredited - logo etched onto internal backplate for home-owner peace-of-mind
- Sold complete with three fixing screw sizes & two spindles to fit all common door thicknesses
- Suitable for PVCu, timber and aluminium patio doors

FINISHES

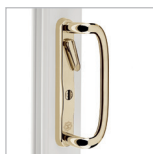

Polished Gold



Polished Chrome



Smokey Chrome



Smooth Satin
Chrome



White



Black

ProSecure Patio Handle

Enhanced Security

Patios & Folding
Sliding Doors



TECHNICAL DRAWINGS

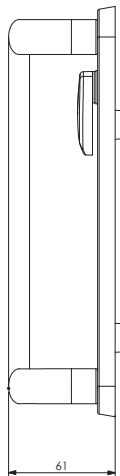
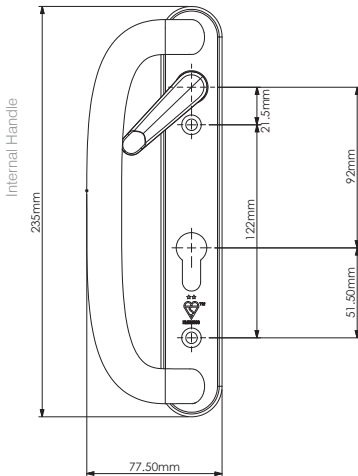
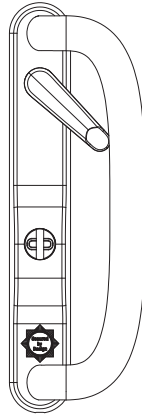
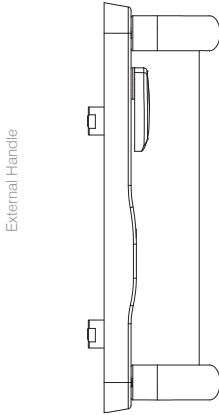

GUARANTEES



Police Preferred Specification



PART NUMBERS

Description	Polished Gold	Polished Chrome	Smokey Chrome	Smooth Satin Chrome	Black	White
ProSecure Patio Handleset	108901	108904	108905	108906	108907	108908



ProLinea Patio Handle

PRODUCT DESCRIPTION



- Manufactured from aluminium (painted finishes) and zinc (plated finishes)
- The long D-shaped lever is styled for optimum comfort and ease of use
- Reversible, suitable for left or right handed doors
- Suitable for PVCu, timber and aluminium patio doors
- Available in 6 combinations of lever, blind and blank, with and without PZ's to suit most applications
- Supplied complete with fixing screws as standard
- Operational reliability - independently tested to 50,000 cycles
- Weather resistance - independently salt spray tested to 240 hours (plated finishes) & 480 (powder coated finishes)

GUARANTEES



FINISHES

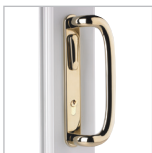

Polished Gold



Polished Chrome



Smokey Chrome



Smooth Satin
Chrome



White



Black

ProLinea Patio Handle

Patios & Folding
Sliding Doors



TECHNICAL DRAWINGS

1. Internal PZ with lever/External PZ with lever

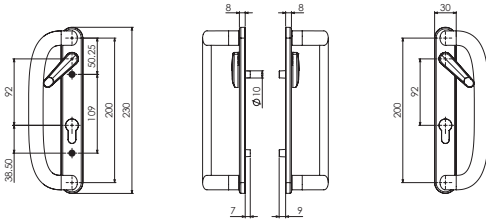

2. Internal PZ with lever/External blind with lever

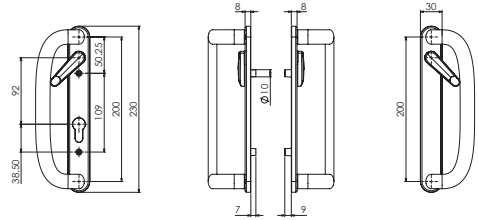

3. Internal PZ with lever/External blank

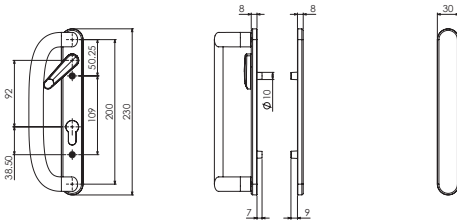

4. Internal blind/External blind

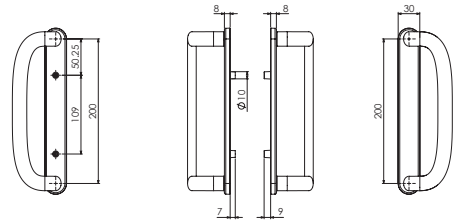

5. Internal blind with lever/External blank

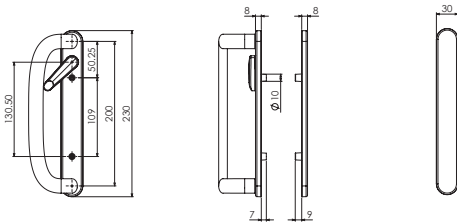

6. Internal blind/External blank

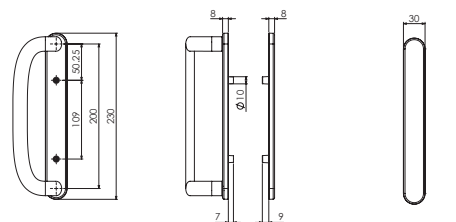

PART NUMBERS

Version	Polished Gold	Polished Chrome	Smooth Satin Chrome	Smokey Chrome	Black	White
1. Internal/External with PZ	108804	108800	108806	108805	108807	108808
2. Internal PZ with lever/External blind with lever	108814	108810	108816	108815	108817	108818
3. Internal PZ with lever/External blank	108824	108820	108826	108825	108827	108828
4. Internal blind/External blind	108854	108850	108856	108855	108857	108858
5. Internal blind with lever/External blank	108844	108840	108846	108845	108847	108848
6. Internal blind/External blank	108834	108830	108836	108835	108837	108838



Tilt & Slide Patio Handle

Hoppe

PRODUCT DESCRIPTION



Aluminium handle suitable for use on all tilt & slide patio systems

- Handle operates all functions of the patio gearing
- Extended lever for smooth operation
- Available in 3 versions - internal non-locking, internal locking, internal & external locking
- Available in 3 finishes - anodised silver F1, anodised gold F3 and white

FINISHES



Anodised Silver F1



Anodised Gold F3



White

Tilt & Slide Patio Handle

Hoppe

Patios & Folding
Sliding Doors



TECHNICAL DRAWINGS

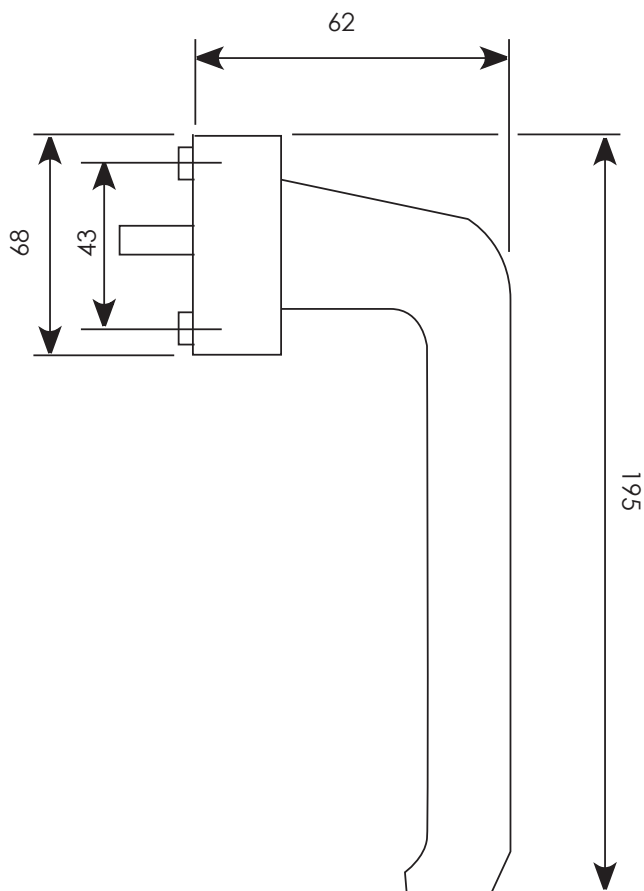

GUARANTEES



PART NUMBERS

Description	Type	Silver F1	Gold F3	White
Tilt & Slide Patio Handle	Internal Locking	103020H	103023H	103025H
Tilt & Slide Patio Handle	Internal/External Locking	103030H	103033H	103035H



PRODUCT DESCRIPTION

- Suitable for all profiles, slim and chamfered
- Roller cams on corner drives as standard
- Increased clearance between sash and frame, therefore it is not necessary to use "slim" or "low" external handles
- Simple height adjustment of +4mm/-2mm
- 160kg load capacity
- No jigs required for bogie wheels
- Mushroom cam option available for enhanced security
- Shootbolt option available
- Suitable for PVCu, timber and aluminium profiles

GUARANTEES



PRODUCT PACKS

*Basic Carton	L/H	R/H	
	530140	530141	
**Track Pack	White	Brown	Silver
87/200	530500	530501	530502
107/240	530510	530511	530512
130/286	530520	530521	530522
160/346	530530	530531	530532
**Cover K Pack	White	Brown	Silver
87	530155	530163	530155
107	530160	530164	
130	530161		
160	530158		530158

PART NUMBERS

No.	Description	Part No.
01	Handle (variant dependant)	1030..
03.	Corner Drive VS S-ES	320099
04	Front Bogie V*	531000
05	Rear Bogie H*	531002
06	Slider*	530916
07	Portal Key*	530917
08	Cover rail L**	531046
09	. Connecting rod**	530900
10	. Guiding rail**	-
11	. Cover rail F**	531054
12	. Running rail**	-
13	. Cover cap L R/H**	531022
14	. Cover cap L L/H**	531022
15	. Cover cap F R/H**	531022
16	. Cover cap F L/H**	531022
17	. Stop**	531026
18	Stop**	531028
19	End Cap**	531030
20	Locking part**	-
21	Support L**	-
22	Tilt stay PSK 160***	530170
23	Cover rail K***	530159
24	Cover cap K R/H***	531018
25	Cover cap K L/H***	531019
26	Support K***	-
27	Linkage (variant dependent)	342...
28	Gear 3 (variant dependent)	340...
29	Linkage (variant dependent)	342...
30	Striker Plate 56	Profile related
31	Striker Plate S-ES	Profile related
32	Tilt lock bearing	Profile related

* Dependent on handing

** Dependent on overall width of profile

*** Dependent on sash width of patio

PSK160 Plus

Tilt & Slide Patio Gear

Patios & Folding
Sliding Doors



TECHNICAL DRAWINGS

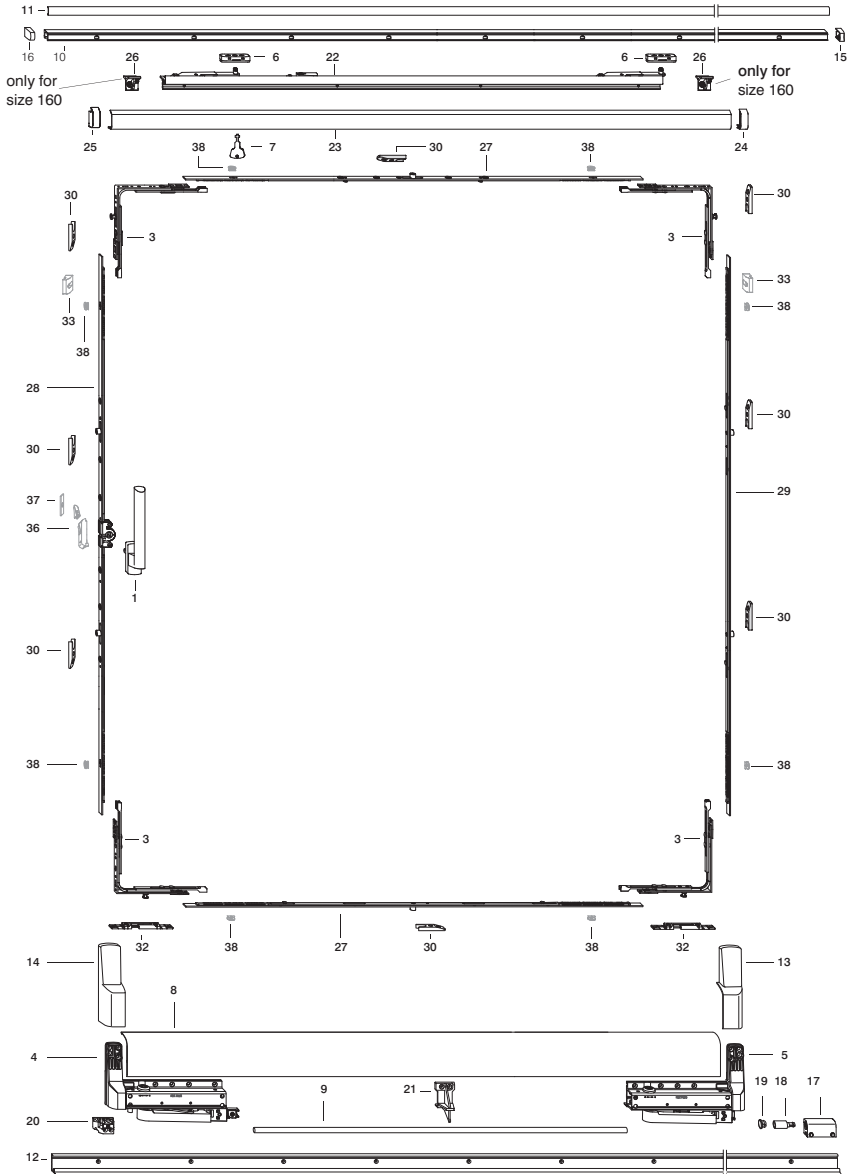



HS Portal

Lift & Slide Patio Gear

SIEGENIA®
brings spaces to life

PRODUCT DESCRIPTION



Lift and slide patio gearing. Easy to assemble, effortless operation.

- Fixed bogie wheels
- Simple frame corner connections
- Pre-moulded sealing rail (optional)
- Suitable for 56mm, 66mm and 68mm timber sections
- Built-in night vent as standard
- Maximum sash weight 400 kg
- Easy to replace clip-on running rail for aluminium sills
- Thermally broken aluminium threshold
- Timber sill option also available
- Low threshold version for wheelchair access
- Insulated support rail
- Shootbolt option available

HS Portal Lift & Slide

Lift & Slide Patio Gear



TECHNICAL DRAWINGS

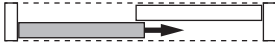

Scheme A*
Moving sashes 1
Max. Width 6,700mm
* Left hand shown above, right hand also available

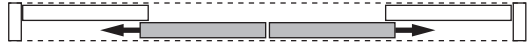

Scheme C
Moving sashes 2
Max. Width 13,300mm

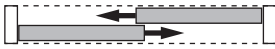

Scheme D
Moving sashes 2
Max. Width 6,700mm

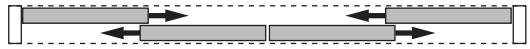

Scheme F
Moving sashes 4
Max. Width 13,300mm



Scheme G
Moving sashes 1
Max. Width 9,900mm



Scheme K
Moving sashes 2
Max. Width 13,300mm



Scheme H
Moving sashes 3
Max. Width 9,900mm



Scheme L
Moving sashes 4
Max. Width 19,800mm



Scheme E
Moving sashes 2
Max. Width 10,000mm

GUARANTEES





FS Portal Plus

Folding Sliding Doors

SIEGENIA®
brings spaces to life

PRODUCT DESCRIPTION



The 2 to 7 pane system allows for greater versatility and a wider opening area than either patio or French doors, increasing the natural light and ventilation.

Folding sliding doors can be fitted to conservatories, patios, roof gardens, balconies or extensions.

- A range of configurations can be achieved - 1 master leaf and a combination of slave leaves. See technical drawing opposite.
- Top or bottom running with one profile set
- Sturdy track with minimal threshold height
- Low threshold option (for open in only)
- Smooth sliding action provided by 4 wheeled bogies with high precision ball bearings
- Option of 2-7 pane system for versatility
- Maximum sash weight up to 80kg
- Suitable for sash rebates widths 330mm - 900mm
- Suitable for sash rebates heights 840mm - 2360mm
- Can be used in conjunction with tilt and turn hardware, offering a secure tilt position for ventilation
- Option of high security multipoint locking
- On the primary door - option of ProSecure or Evolution security door hinges in a range of finishes
- Suitable for timber, PVCu and aluminium doors and windows

GUARANTEE





TECHNICAL INFORMATION

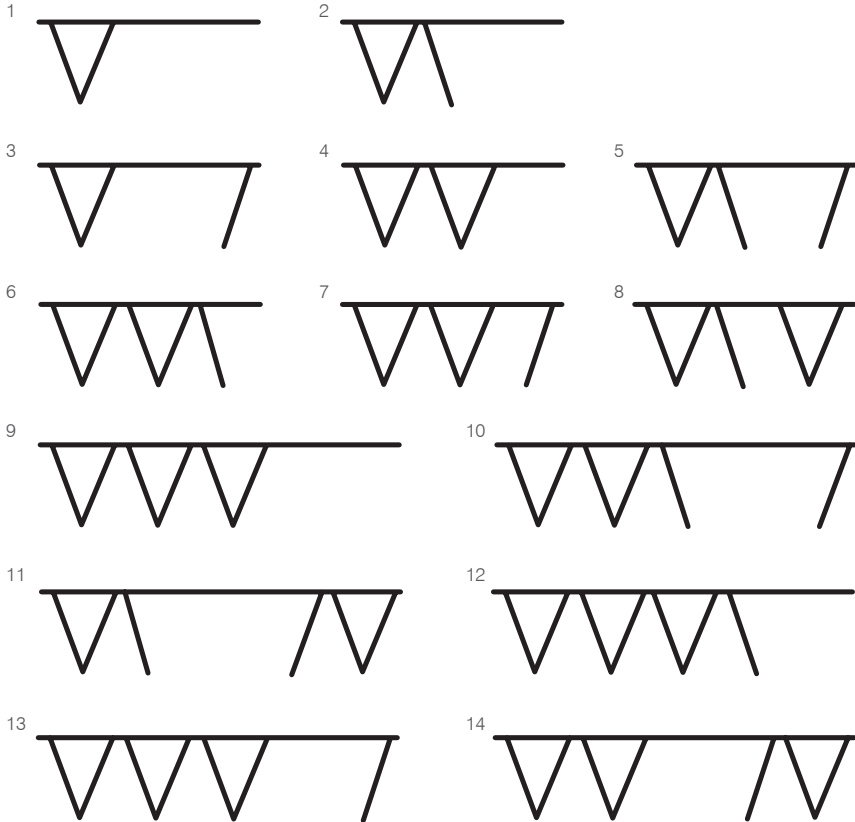

No.	Scheme	Max Frame Width (mm)	No.	Scheme	Max Frame Width (mm)
1	220	1.80	8	532	4000
2	330	2700	9	660	5400
3	321	2700	10	651	5400
4	440	3600	11	633	5400
5	431	3600	12	770	6300
6	550	4000	13	761	6300
7	541	4000	14	743	6300



Patio Lock

6 Hook



Secured by Design



Police Preferred Specification

PRODUCT DESCRIPTION



High security locking system for inline patio doors systems with a 16mm eurogroove

- 6 hooks provide multipoint locking
- Hooks provide enhanced security anti-lift protection
- Safety - a mishandling device integrated into the locking mechanism prevents the door from being accidentally slammed shut
- Corrosion resistance - independently tested to EN1670:2007 Grade 4
- Operational reliability - Independently tested to 100,000 cycles
- Enhanced security - tested to PAS 24: 2012
- One piece steel striker available - enhances aesthetics, increases security and speeds fabrication time

Patio Lock

6 Hook

Patios & Folding
Sliding Doors



TECHNICAL DRAWINGS

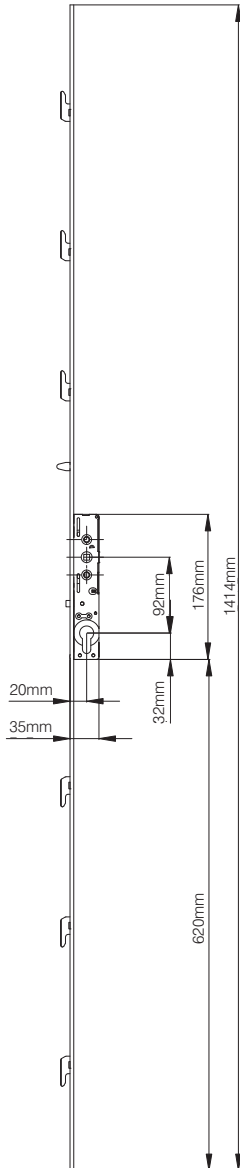

CLOSE UP



PART NUMBERS

Description

6 Hook Patio Lock

Part No.

108305

GUARANTEE



Secured by Design





Patio Lock

4 Hook



Secured by Design



Police Preferred Specification

PRODUCT DESCRIPTION



High security locking system for inline patio doors systems with a 16mm eurogroove

- 6 hooks provide multipoint locking
- Hooks provide enhanced security anti-lift protection
- Safety - a mishandling device integrated into the locking mechanism prevents the door from being accidentally slammed shut
- Corrosion resistance - independently tested to EN1670:2007 Grade 4
- Operational reliability - Independently tested to 100,000 cycles
- Enhanced security - tested to PAS 24: 2012
- One piece steel striker available - enhances aesthetics, increases security and speeds fabrication time

Patio Lock

4 Hook



TECHNICAL DRAWINGS

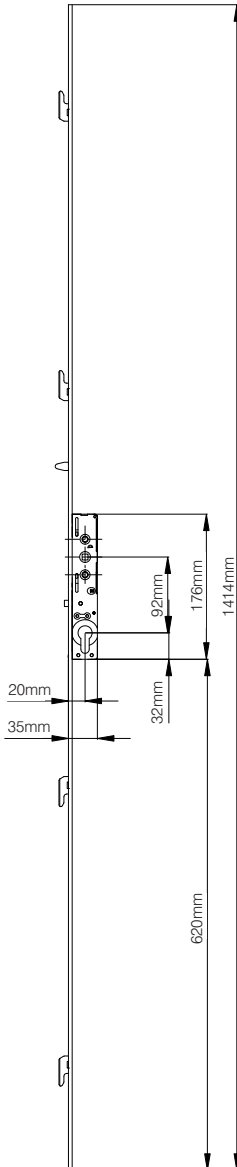

CLOSE UP



PART NUMBERS

Description	Part No.
4 Hook Patio Lock	108302

GUARANTEE





PRODUCT INFORMATION



- Plastic moulded patio stop with integrated rubber buffer
- Prevents patio door from slamming into wall
- Available in 3 colours
- Simple to fit

FINISHES



Black
with black buffer



Brown
with black buffer



White
with black buffer



White
with white buffer

PART NUMBERS

Description	Black	Brown	White
Patio Stop with Black Buffer	108592	108591	108590
Patio Stop with White Buffer	-	-	108593



PRODUCT INFORMATION



- Roller with 2 wheels for use on inline sliding patio systems
- Available with nylon or steel wheels
- Wheels available in 3 widths - 2mm, 2,5mm and 3mm
- Simple to fit

CLOSE-UP



Nylon Wheels

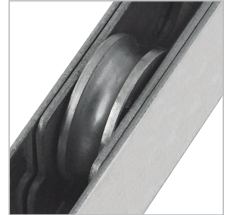

Stainless Steel
Wheels

PART NUMBERS

Description	Size	Part Number
Inline Patio Roller With Nylon Wheels		520564
Inline Patio Roller With Stainless Steel Wheels	2mm	520580
Inline Patio Roller With Stainless Steel Wheels	2.5mm	520581
Inline Patio Roller With Stainless Steel Wheels	3mm	520582