

Technical Data

Type	Mortice
Operation	Cylinder
Pz (mm)	92
Backset (mm)	30, 35, 40, 45
Faceplate (mm)	24
Box Quantity	1

Technical Drawing

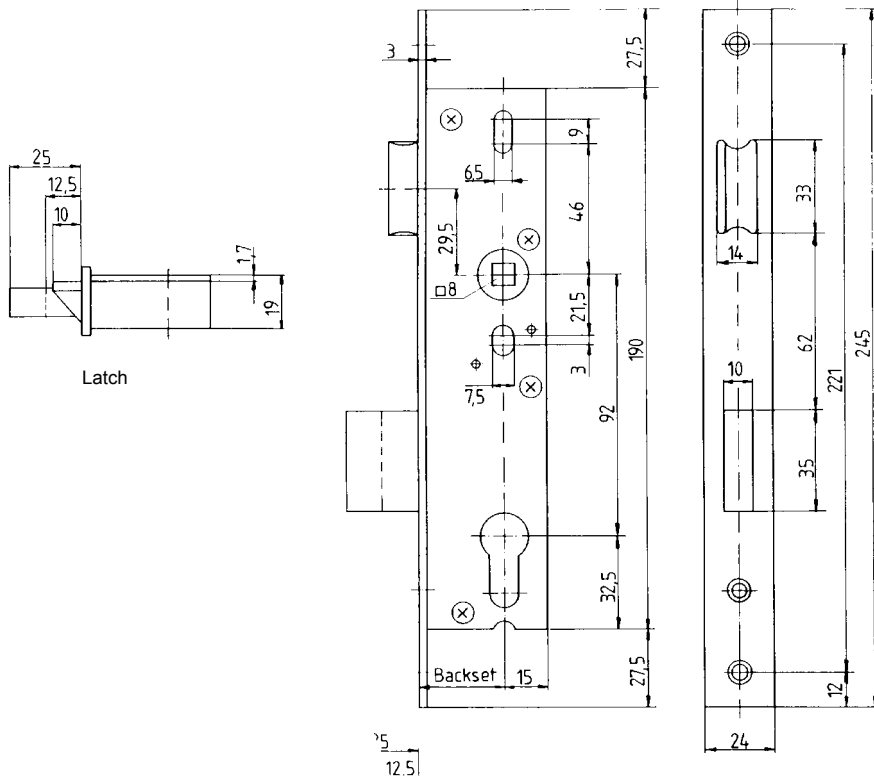

39 PZW Mortice Lock

Security mortice lock with deadbolt and reversible latch.

- Deadbolt operated by cylinder
- Latchbolt can be operated by handle or cylinder
- Deadbolt has 25mm double throw
- Deadbolt is protected against sawing with hardened steel pins
- 24mm faceplate
- Available in a range of backset sizes
- Suits standard lever/lever or lever/pull pad handles with PZ 92



Part Numbers

Description	Backset (mm)	Hammerlatch	Stainless Steel
39 PZW	30	040550	040551*
39 PZW	35	040558*	040559
39 PZW	40	040566*	040567*
39 PZW	45	040574*	040575*

Guarantees & Accreditations

Mechanical Guarantee	5 years
Labour Guarantee	2 years

to place your order simply call our sales team direct on 01327 312 400